



DRIJA

2 YEARS WARRANTY

Quadrato 76 Black

Range Hood



INCLUDED

2 ACTIVE CARBON FILTERS



RANGE HOODS



COOKTOPS



MICROWAVES



OVENS



WINE COOLERS



REFRIGERATORS



GAS WATER HEATERS



SCAN FOR MORE INFORMATION

USER MANUAL

110V / 60Hz

NOTA: Para adquirir accesorios y/o repuestos de este producto, contáctenos al Contact Center (según el número de su país que le indique el certificado de garantía o a nuestras redes sociales)

NOTE: To purchase accessories and / or spare parts for this product, contact us at the Contact Center (depending on the number of your country that indicates the warranty certificate or our social media)

www.drjainternational.com

Para conservar la garantía de este producto es indispensable instalarlo a no menos de **76 cm** de la Estufa

To keep the warranty, you must install the hood at **76 cm** from the cooktop



Content

Important Safety Instructions	2
Notice	3
Features	4
Instalation	4
How to use your product.....	6
Installation notice	7
Maintenance	8
Troubles shootings	9
Environmental protection	10

Important Safety Instructions

- Do not let children operate the machine.
- The extractor hood is for domestic use only, it is not suitable for barbecues, grills, and other commercial purposes.
- The extractor hood and its filter must be cleaned regularly to keep them in good working condition.
- Clean the cooker hood according to the instruction manual and prevent the appliance from burning. If the power cable is damaged, it must be replaced by the manufacturer; the ifs service technician or similarly qualified persons to avoid a hazard.
- Prohibit direct cooking from the gas stove.
- Maintain a good convection stove.
- Before connecting this appliance, check that the power cord is not damaged. A damaged power cord should only be replaced by qualified service personnel. There is a risk of fire if cleaning is not carried out according to the instructions.
- When the cooker hood is used simultaneously with appliances burning gas or other fuels, there must be adequate ventilation of the room.
- Air must not be discharged into a flue used to exhaust appliances burning gas or other fuels.
- Regulations regarding air discharge must be complied with.
- Children should be supervised to ensure they do not play with the appliance.
- Do not light a fire under the cooker hood.
- The cooker hood is not intended to be installed over a hob with more than four cooking elements.
- This appliance is not intended for use by persons (including children) with reduced physical, sensory, or mental capabilities, or lack of experience and knowledge unless they have been given supervision or instruction concerning the use of the appliance by a person responsible for their safety.
- Children should be supervised to ensure they do not play with the appliance.
- Air must not be discharged into a chimney which is used for the exhaust of fumes from gas or other fuel-burning appliances when the extractor hood and appliances are powered by other energy.



Electric Shock Hazard

Plug this unit into a grounded outlet only. If in doubt, consult a qualified technician for advice.

Failure to follow these instructions may result in death, fire, or electric shock.

The instructions shall indicate the contents of the following

- There shall be adequate ventilation of the room when the fume hood is used in conjunction with appliances burning gas or other fuels (not applicable to appliances that only discharge air into the room);
- Details regarding the method and frequency of cleaning;
- There is a risk of fire if cleaning is not carried out in accordance with The instructions;
- Caution: Accessible parts may become hot when used with cooking appliances;
- Air must not be discharged into a duct that is used for exhausting fumes from appliances that burn gas or other fuels (does not apply to appliances that only discharge air back into the room);
- The minimum distance between the support surface of the cooking vessels on the hob and the lowest part of the cooker hood (When the cooker hood is located above a gas appliance, this distance shall be at least 76 cm.
- The regulations concerning air discharge must be complied with.

The installation instructions for range hoods with accessible Class II metal enclosures shall include details indicating the location and maximum allowable lengths for any set or mounting screws or other fastening device that penetrates the range hood to attach an accessory such as a fascia or duct fitting.

Notice

- Thank you for choosing our range hood. Please read the instruction manual carefully before use.
- Installation work must be carried out by a qualified and competent installer.
- The manufacturer disclaims all liability for damages caused by failure to follow the installation instructions contained in the following text.

The extractor hood is used voltage on 110V / 60 Hz.

User Manual
RANGE HOOD | QUADRATO 76 BLACK

DRIJA

Features

- The extractor hood uses high quality materials, and is made with streamlined design.
- Equipped with high power and low noise electric motor and centrifugal blade, it produces strong suction, low noise, anti-grease filter and easy to clean.
- With low voltage isolated circuit board control, 12V DC input, the lights are thus safer.
- Special wind tunnel construction and oil collector design, the free dirt will be sucked in one second.

Installation

Product one:

- The cooker hood should be placed at a distance of 76 cm (30 inches) from the cooking surface for best effect.

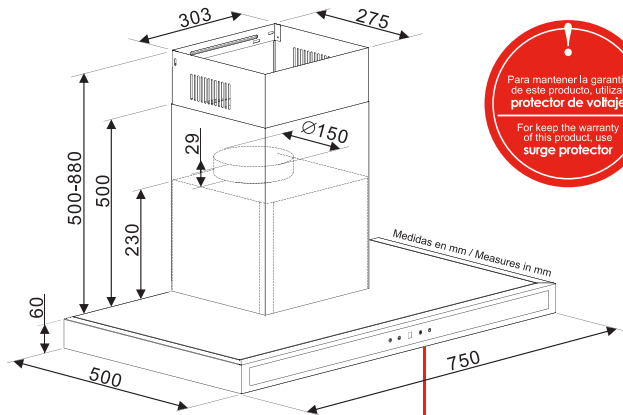

Para mantener la garantía de este producto, utilizar **protector de voltaje**
For keep the warranty of this product, use **surge protector**

Extracción de partículas de grasa y olores
Extraction of grease particles and odors

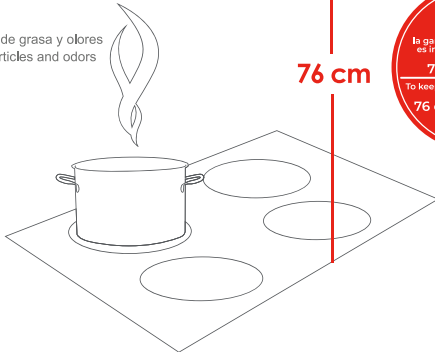

76 cm

Para conservar la garantía de este producto es indispensable instalarlo a no menos de **76 cm** de la Estufa.
To keep the warranty, you must install the hood at **76 cm** from the cooktop.

- The fixed position of the inner chimney support is the place of the chimney.
- Fix the outer chimney bracket on the outer chimney, and make sure that the inner chimney can be adjusted in height freely, as well as fix the extendable pipe. Then install the extension pipe.

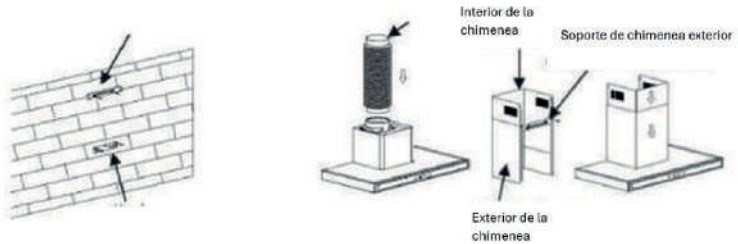

- Place the extractor hood on the hook.
- Adjust the height of the inner chimney to the position of the inner chimney support and fix it with a screw, after adjusting the position, fix the body with a safety screw.



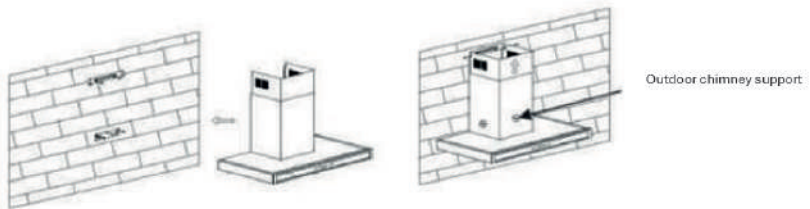

Note: The two safety vents are placed on the rear casing, with a diameter of 6 mm.

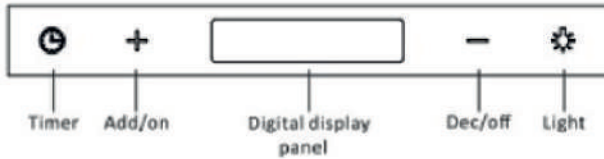

How to use your product



Touch control switch

-  1. Timer, which can be set from one minute to 60 minutes.
-  2. Light on and off
-  3. Speed increasing from low to medium to high in sequence.
-  4. Speed decreasing by sequence from high to medium, and to low until the power stops running.

Touch switch.

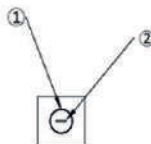

- 1. Illumination changing red/yellow/blue according to the speed setting.
- 2. Constant white illumination during operation.

Functions

1. Press the button for two seconds, the motor starts to run at low speed and the illumination lights up;
2. If the button is pressed gently again, it switches to medium speed and the illumination lights up;
3. Press once more, it switches to high speed and the illumination is on; if press again, it will switch to low speed and go to cycles as above any running condition, press two seconds, it will turn off.

Installation Notice

1. Before installation, make sure the area is clean to avoid the suction of the broken wood debris and dust.
2. It can not share the same air vent pipe with other appliance, such as gas pipe, heater pipe and hot wind pipe.
3. The curvature of the vent pipe should be $> 120^\circ$ parallel or higher to the starting point and should be connected to the outside wall.
4. After installation, make sure the exhaust fan is level to avoid grease accumulation at one end.

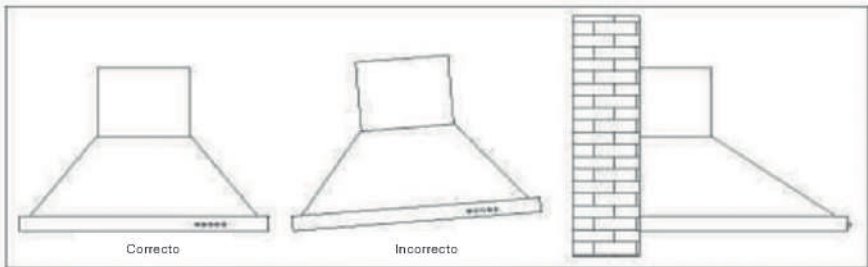

Maintenance

Cleaning of the carbon grease filter screen

The filter mesh is made of high density stainless steel. Please do not use corrosive detergent on it. Keeping this filter clean will make the appliance work properly. Please strictly follow the following guidelines.

Method 1: Put the screen in 40-50 cc of clean water, pour detergent and soak it for 2-3 minutes. Wear gloves and clean with a soft brush. Do not apply too much pressure, as the mesh is delicate and will be easily damaged.

Method 2: If instructed, it can be put in the dishwasher, setting the temperature to about 60 degrees.

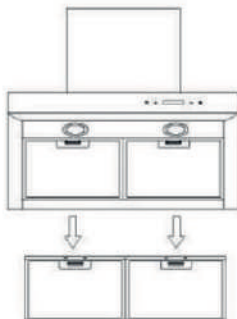

Notice on cleaning the cooker hood

1. To protect the main body from corrosion over a long period, the cooker hood should be cleaned with hot water plus non-corrosive detergent every two months.
2. Please do not use abrasive detergent or deodorant because it will damage the body.
3. Keep the motor and other parts free of water, as this will cause damage to the appliance.
4. Before cleaning the appliance, remember to turn off the power.
5. The charcoal filter should not be exposed to heat.
6. Do not break the fixed bar around the charcoal filter.
7. If the plug or cable is damaged, replace it with a special soft cable.
8. Cleaning and maintenance should not be carried out by unsupervised children.

Trouble Shootings

Failure	Possible cause	Solutions
Light on, but motor does not run	Blade is blocked	Get rid of the blockage
	Capacitor is damaged	Replace capacitor
	The motor is stuck	Replace the motor
Light does not work, motor does not work	In addition to the above, check the following:	
	Damaged light	Replace lights
	Power cable comes loose	Connect the wires according to the wiring diagram
Oil leakage	One-way valve and vent air inlet not sealed properly	Disassemble the one-way valve and seal it with glue.
	Leakage at the connection of the U-selector and the cap	Bring U-shaped section down and seal soap
Agitation of the fume hood body	Blade damaged and causes tremors	Replace the blade
	The motor is not securely fastened	Lock the motor securely
	The motor is not hung properly	Firmly fix the body
Insufficient suction	The motor is not hung properly	Resetting the distance
	Too much ventilation through open doors or windows	Choose a new location and reassemble the machine.
The extractor hood	The fastening screw is not sufficiently tightened	Tighten the suspension screw and put it in horizontal position.
	Hanging screw not tightened sufficiently	Tighten the suspension screw and put it in horizontal position.

Environmental Protection

Waste electrical products should not be disposed of with household waste.

Please recycle where facilities exist. Consult your local authorities or your distributor for advice on recycling.



DRIJA

UP TO

2 YEARS
WARRANTY

BUILT-IN
HOME APPLIANCES



RANGE HOODS



COOKTOPS



MICROWAVES



OVENS



WINE COOLERS



REFRIGERATORS



WATER HEATERS